

# REMOTE CONTROL

The remote control provided with this unit is designed to control all the most commonly used functions of the unit. If the CD player, tuner, turntable and tape deck connected to this unit are YAMAHA components designed for remote control compatibility, then this remote control will also control the various functions of those components.

## KEY FUNCTIONS

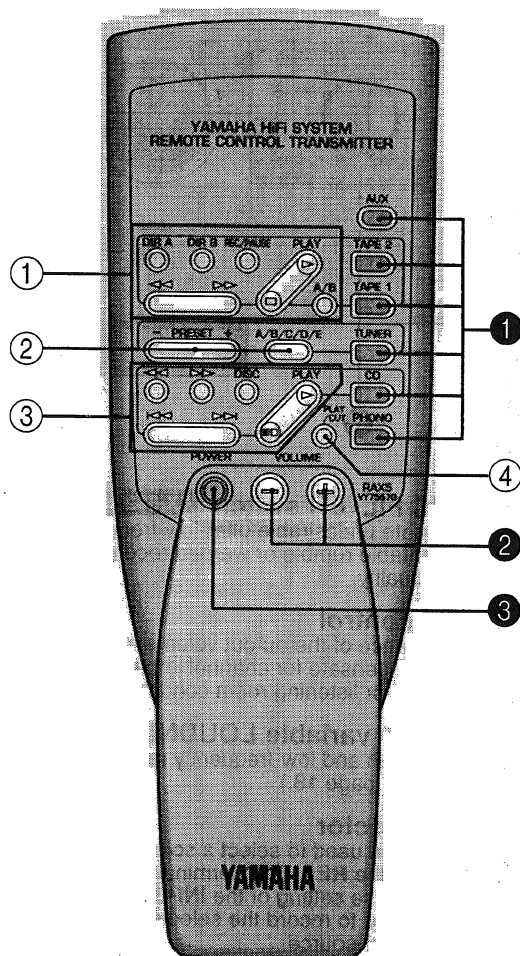

\* The AX-492's remote control does not have a **PLAY/CUT** key

### To control this unit

#### ① Input selector keys

Select an input source.

#### ② VOLUME +/- keys

Adjust the volume level.

#### ③ POWER key

Turns the power on and off.

<Except for U.S.A. and Canada models>

While the power is on, pressing the **POWER** key on the remote control switches the unit from the power-on mode to the standby mode and vice versa. (In this mode, the power indicator on the unit is half-illuminated.)

### To control other components

Identify the remote control keys with your component's keys. If the keys are identical, the functions will be the same. If the keys are different, refer to the component's manual for their functions.

#### ① Tape deck keys

Control the tape deck.

- **DIR A**, **DIR B**, and **A/B** are applicable only for a dual tape deck.
- For a single tape deck with an automatic reverse function, pressing **DIR A** will reverse the direction of the tape.

#### ② Tuner keys

Control the tuner.

+: Selects a higher preset station number.

-: Selects a lower preset station number.

**A/B/C/D/E**: Selects a group (A-E) of preset stations.

#### ③ CD player keys

Control the compact disc player.

- **DISC** is applicable only for a compact disc changer.

#### ④ **PLAY/CUT** key **AX-592 and AX-892 only**

Press **PLAY/CUT** to lower the pick-up arm and press it again to raise the arm.

## Battery installation

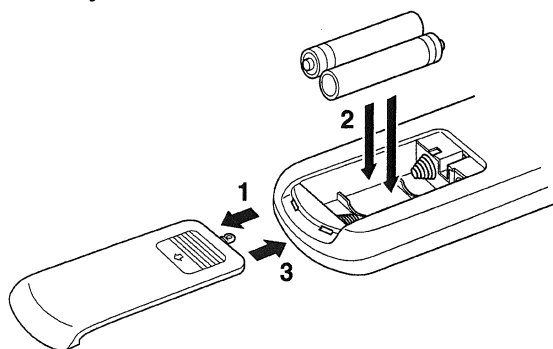

## Battery replacement

If you find that the remote control must be used closer to the unit, the batteries are weak. Replace both batteries with new ones.

### Note

- Use only AA, R6, UM-3 batteries for replacement.
- Be sure the polarities are correct. (See the illustration inside the battery compartment.)
- Remove the batteries if the remote control will not be used for an extended period of time.
- If batteries leak, dispose of them immediately. Avoid touching the leaked material or letting it come in contact with clothing, etc. Clean the battery compartment thoroughly before installing new batteries.

## Remote control operation range

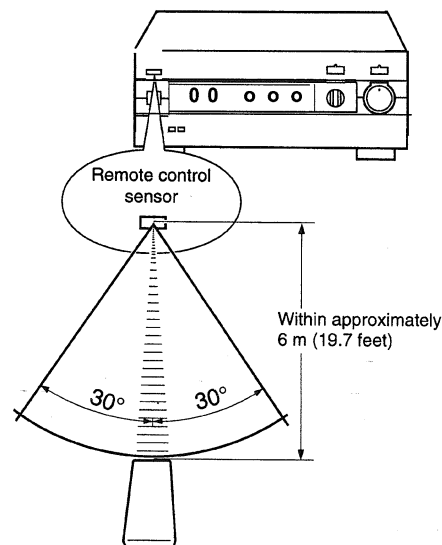

### Note

- There should be no large obstacles between the remote control and the unit.
- If the remote control sensor is directly illuminated by strong lighting (especially an inverter type of fluorescent lamp etc.), it might prevent the remote control from working. In this case, reposition the unit to avoid direct lighting.

## Opening and closing the control door

When using the remote control or when it is not necessary to operate controls inside the control door, close it.

To open the door

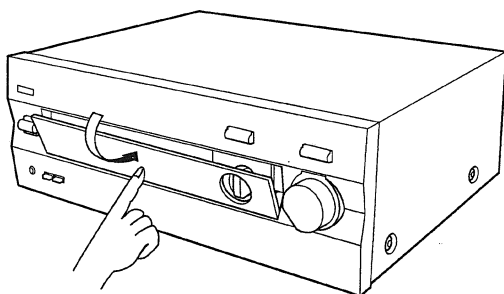

To close the door

